



Alpine Foods Announces Expansions to Milwaukie, OR and Vernon, CA Facilities

Alpine Foods is pleased to announce significant expansions to its operations in both Milwaukie, OR, and Vernon, CA! The decision to invest heavily in these expansions underscores Alpine Foods' commitment to meeting the evolving needs of its customers while strategically positioning the company for continued growth.

In Milwaukie, Alpine Foods is converting an existing dry storage facility into a state-of-the-art refrigerated warehouse. Scheduled for completion in June 2024, this project also includes the construction of a new freezer and cooler. The existing structure will be demolished, making way for modern offices, break rooms, and shipping/receiving doors. Covering an expansive area of over 500,000 square feet, the Milwaukie expansion is poised to play a pivotal role in Alpine's growth trajectory, enhancing capabilities for line expansion and welcoming 20-30 associates to the Alpine Foods team within the next year.

A NEW PROJECT FOR:
ALPINE FOOD DISTRIBUTING, LLC.
ALPINE FOOD DISTRIBUTING FREEZER
MILWAUKIE, OREGON

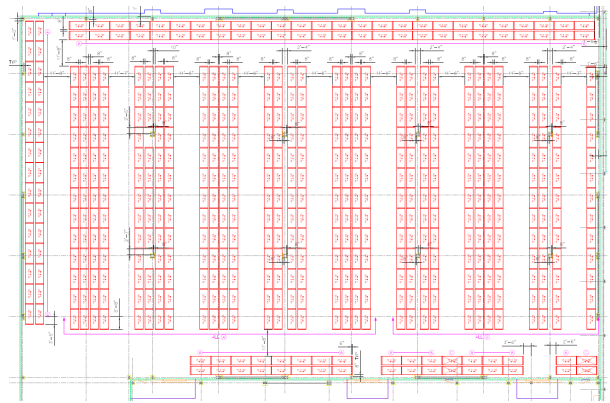
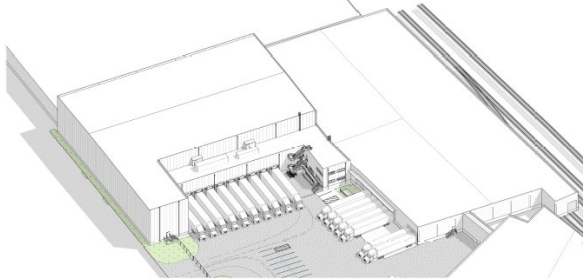

In June 2023, Alpine Foods initiated the groundbreaking for the conversion of an existing 60,000 square-foot warehouse into a cutting-edge 3M Cubic Foot Freezer, complemented by the addition of a new 10,000 square-foot cooler. This \$19M project involves a complete demolition of the existing structure, replacing it with a brand-new 50' structure. The upgraded facility will boast additional offices, a break room, and 10 new shipping and receiving doors, with a total capacity of 10,000 commercial pallet positions.

In tandem with its Milwaukie expansion, Alpine Foods proudly announces the acquisition of a new distribution facility in Vernon, CA. Anticipated to be operational in late 2024, this 116,000-square-foot facility strategically situates Alpine Foods in Southern California, enhancing its ability to meet the heightened demand for superior service and fulfillment levels, particularly in the southwest market. The new facility promises increased operational efficiencies, shorter lead times, just-in-time product availability, and additional resources for seamless operations.

The Vernon facility is designed to include 40,000 square feet of freezer and refrigerated space, 50,000 square feet of ambient storage, a refrigerated shipping and receiving dock, rail accessibility, and 10,000 square feet of office space and break rooms. This expansion marks a significant milestone for Alpine Foods, reinforcing its commitment to excellence and responsiveness in meeting the dynamic needs of its customers.

